



Stock Thickness:
 RH = .05
 RJ = .06
 RK = .06
 RL = .07
 RM = .07

Nylon Insulated Ring – continued

Cat. No.	Pkg. Qty.	Wire Range	Max. Ins.	Bolt Hole	Wt./Lbs. Per 1000	Dimensions			
						A	B	C	M
RH9711	100	1AN	.500	1/4"	54	2.14	.77	.44	1.81
RH9731	100	1AN	.500	3/8"	54	2.14	.77	.44	1.81
RH9751	100	1AN	.500	1/2"	54	2.34	.77	.54	1.90
RJ9711	100	1/0AN	.550	1/4"	80	2.35	.83	.46	1.97
RJ9731	100	1/0AN	.550	3/8"	80	2.35	.83	.46	1.97
RJ9751	100	1/0AN	.550	1/2"	80	2.49	.89	.55	2.04
RH717	100	1/0	.629	1/4"	80	2.14	.77	.43	1.81
RH727	100	1/0	.629	5/16"	80	2.14	.77	.43	1.81
RH737	100	1/0	.629	3/8"	80	2.14	.77	.43	1.81
RH757	100	1/0	.629	1/2"	80	2.34	.77	.54	1.90
RK9731	100	2/0AN	.610	3/8"	70	2.52	.93	.55	2.14
RK9751	100	2/0AN	.610	1/2"	70	2.60	.93	.55	2.15
RJ717	100	2/0	.675	1/4"	80	2.34	.83	.46	1.96
RJ727	100	2/0	.675	5/16"	80	2.34	.83	.46	1.96
RJ737	100	2/0	.675	3/8"	80	2.34	.83	.46	1.96
RJ757	100	2/0	.675	1/2"	80	2.48	.89	.54	2.03
RL9731	100	3/0AN	.680	3/8"	120	2.83	1.04	.57	2.36
RL9751	100	3/0AN	.680	1/2"	120	2.83	1.04	.57	2.36
RK717	100	3/0	.765	1/4"	84	2.60	.93	.54	2.21
RK727	100	3/0	.765	5/16"	84	2.60	.93	.54	2.21
RK737	100	3/0	.765	3/8"	84	2.60	.93	.54	2.21
RM9731	100	4/0AN	.750	3/8"	160	3.00	1.13	.66	2.51
RM9751	100	4/0AN	.750	1/2"	160	3.00	1.13	.66	2.51
RL737	100	4/0	.785	3/8"	130	2.83	1.04	.57	2.35
RL757	100	4/0	.785	1/2"	130	2.83	1.04	.57	2.35
RM737	100	250MCM	.868	3/8"	130	3.00	1.13	.65	2.51
RM747	100	250MCM	.868	7/16"	130	3.00	1.13	.65	2.51
RM757	100	250MCM	.868	1/2"	130	3.00	1.13	.65	2.51

AN – Aircraft Wire

U.L. Listed E9809

Installing tools: TBM6/TBM6S, ERG-2007, (RD & RE Except Brazed Seam)

Note: Not available on Mylar Tape.

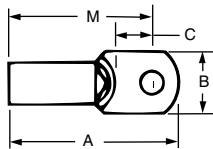

K

Sta-Kon®